

Target oriented COR/DSC control



Target oriented control to achieve a higher transport capacity. Instead of the classic choice, the customer enters the station of destination on the floor terminal. Then the control system efficiently assigns demands from the individual floors to specific elevators and the customer can see the number of the elevator meeting his/her demand on the floor terminal.

COR/DSC

- Increased transport capacity in comparison with classic group control.
- Reduced waiting time for the cab arrival.
- Reduced operating costs by more efficient utilization of elevators.
- Simple interconnection of elevators by means of a bus system.
- Variant designs of floor terminals – touch screen or classic panel boards.
- Visualization, statistics and analysis of elevators' behaviour.

MANUFACTURER:

BETACONTROL

Beta Control s.r.o.

Cerneho 829/58, 635 00 Brno-Bystrc
Czech Republic

www.betacontrol.cz / obchod@betacontrol.cz

Free Consultation!
+420 733 610 313

Target oriented COR/DSC control



Simple operation

- Selection of the required floor.

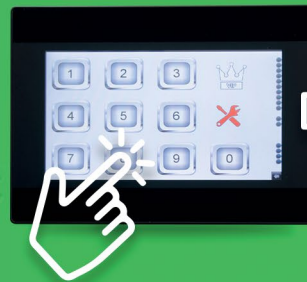

- Elevator selection.



Detailed functionality diagram

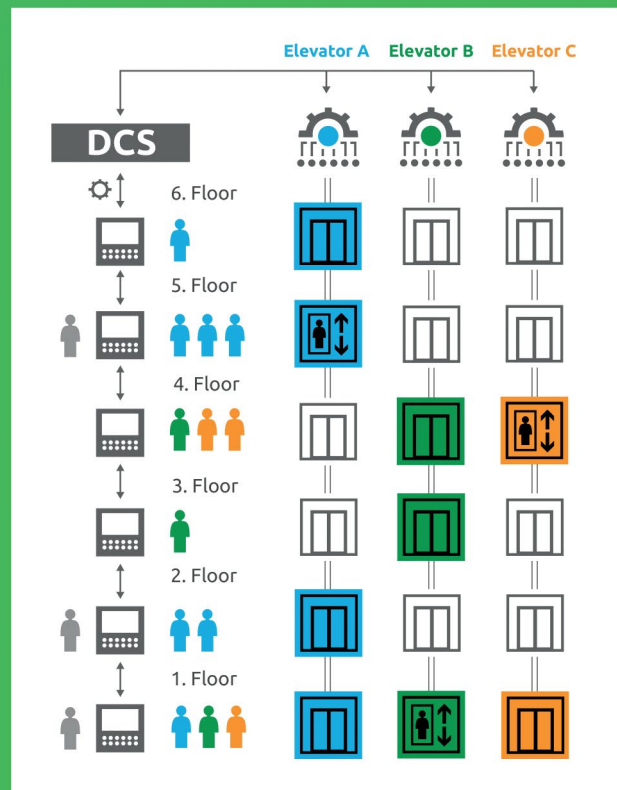

MANUFACTURER:

BETACONTROL

Beta Control s.r.o.

Cerneho 829/58, 635 00 Brno-Bystrc
Czech Republic

www.betacontrol.cz / obchod@betacontrol.cz

Free Consultation!
+420 733 610 313